

ROOF REMOVAL INSTRUCTIONS - FLAT ROOF

*SPECIFICATIONS VARY PER BUILD.

*ALWAYS LIFT ENCLOSURE USING ALL PRE-INSTALLED LIFT POINTS.

1 TO REMOVE ROOF UNFASTEN ALL ATTACHMENT POINTS & MANUALLY LIFT ROOF FROM BUILDING.

2 ROOF ATTACHMENT POINTS: EYEBOLTS

1 TO REMOVE ROOF UNFASTEN ALL EYEBOLTS & MANUALLY LIFT PANEL FROM BUILDING.

1 ENCLOSURE LIFT POINTS (REMOVE TO LIFT ROOF)

2 ROOF ATTACHMENT POINTS

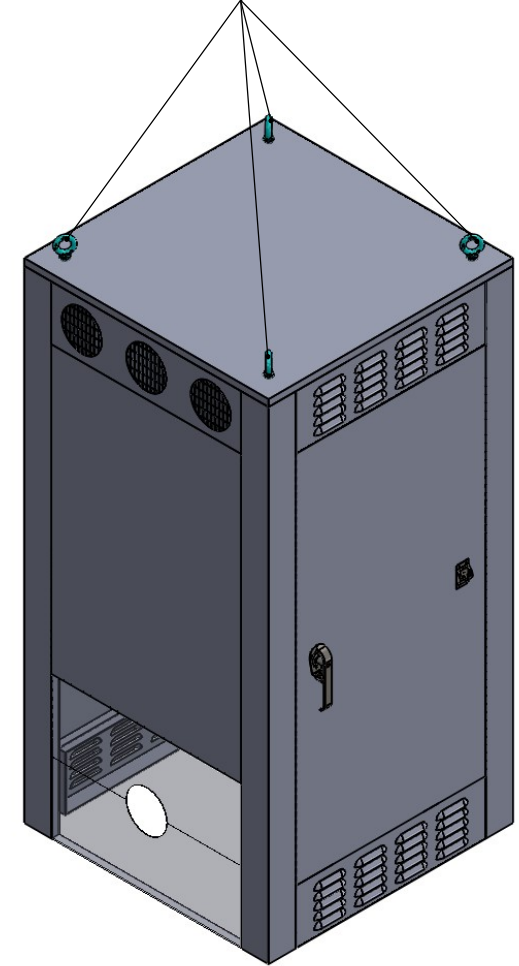
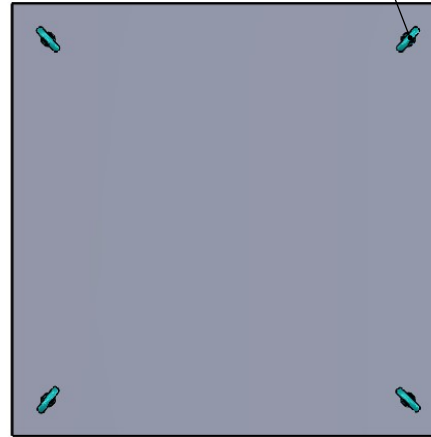
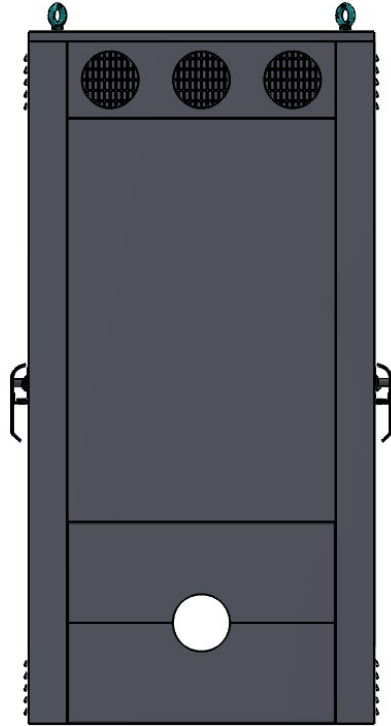

STANDARD MODULE WITH FLAT ROOF



2 RPS QR CODES

* LOOK FOR STICKERS LOCATED ON YOUR UNIT.

* SCAN CODE WITH YOUR PHONE OR DEVICE.

GENERAL NOTES:

1. THIS DOCUMENT IS FOR INSTALLATION & MAINTENANCE REFERENCE ONLY
2. ENCLOSURE SHALL BE INSTALLED BY CONTRACTOR.
3. THE ENCLOSURE SHALL BE INSTALLED WITH A BOOM TRUCK OR EQUIVALENT.
4. THE CONTRACTOR SHALL NOT DISASSEMBLE PUMP ENCLOSURE FOR OR DURING INSTALLATION.
5. CONCRETE SLAB, ELECTRICAL CONNECTIONS AND ANCHOR BOLTS NOT PROVIDED BY RPS INDUSTRIES.
6. SPECIFICATIONS VARY PER BUILD

STANDARD FLAT ROOF			
PROPRIETARY NOTICE THE INFORMATION CONTAINED IN THIS DRAWING IS THE SOLE PROPERTY OF RPS INDUSTRIES. ANY REPRODUCTION IN PART OR AS A WHOLE WITHOUT THE WRITTEN PERMISSION OF RPS INDUSTRIES IS PROHIBITED.		CUSTOMER:	
		TITLE: ROOF INSTALLATION .	
DO NOT SCALE DRAWINGS FROM THIS SHEET		DRAWING NO.	DATE: 5/19/2022
		DRAWN: AJ	REV:
		RPS INDUSTRIES PRECISION SHEET METAL 11105 SW INDUSTRIAL WAY, BLDG 6, BAY 1 TUALATIN, OREGON 97062 PH. 503-691-5972 WWW.RPSUSA.COM	
		SHEET 1 OF 1	